



Feature

1. Metal housing. 2. Available with tap.
3. Center detent option. 4. Metal slide rod type.
5. Long Life Type Available.

Fxx46 Slide potentiometer

Electrical characteristics

- Total Resistance.....1K Ω ~1M Ω
- Total Resistance Tolerance.....500 Ω <R<1M Ω : \pm 20%
R \leq 500 Ω or R \geq 1M Ω : \pm 30%
- Resistance Taper.....A,B,C
- Withstand Voltage.....1 minute at AC 100V
- Insulated Resistance.....More than 100M Ω at DC 100 V
- Sliding Noise.....Less than 100mV
- Residual Resistance.....Term.1~2:Less than 1 Ω
Term.2~3:Less than 1 Ω
- Gang Error (Dual Unit).....- 40dB~0dB \pm 3dB
- Max Operating Voltage.....DC 20V
- Rated Power.....Linear Taper B:0.25W;
Other Tapers:0.125W

Mechanical characteristics

- Slide Travel.....45mm,60mm
- Operating Torque.....Less than 50 gf
- Stopper Strength.....5.0Kgf.cm
(from the base level to a point of 2mm)
- Level Wobble.....2(2xL)/20mm Max.(L:Level length both sides)
- Level Push-Pull Strength.....5.0Kgf Min at 10Sec.

Durability

- Slide Life.....200,000 Cycles Min.
- Operating Temperature Range.....-10 $^{\circ}$ C ~ +70 $^{\circ}$ C

HOW TO ORDER

Fxx46-	G	1	S	B	1	C	100K	1
---------------	----------	----------	----------	----------	----------	----------	-------------	----------

Model Series	
xx	Slide Travel
45	45mm
60	60mm

Code	Gang Option
N	Single Unit
G	Dual Units

Code	Pitch
1	Type 1
2	Type 2
See Note 2	

Code	Dustproof Option
S	No Dustproof Cover
D	with Plastic Dustproof
R	with Nonwoven Dustproof

Slide Lever Type & Length	
See Note 1	

Code	Resistance Taper
A	Audio (15A)
B	Linear (0B)
C	Reverse Audio(15C)
D	Audio (10A)

Total Resistance	
1K	
2K	
5K	
10K	
20K	
50K	
100K	
200K	
500K	
1MEG	

Code	Operation Life
(Blank)	Std. Life w/o anti-sulfur
1	Std. Life w/ anti-sulfur
2	Long Life w/ anti-sulfur
3	Long Life w/o anti-sulfur

Note 1: Slide Lever Type and Length:

A-TYPE(M)		B-TYPE(M)		C-TYPE(M)		D-TYPE(M)				
L	16 20 25	L	8 13 20	L	15 20	L	12.5 15 17 20 25			
F	11 10 10			F	10 10					
M	11 12 12									
CODE	1 2 3	CODE	1 2 3	CODE	1 2	CODE	1 2 3 4 5			

Note 2: Pitch

Code	Pitch	
	F4546	F6046
1	72.5	87.5
2	67.5	82.5

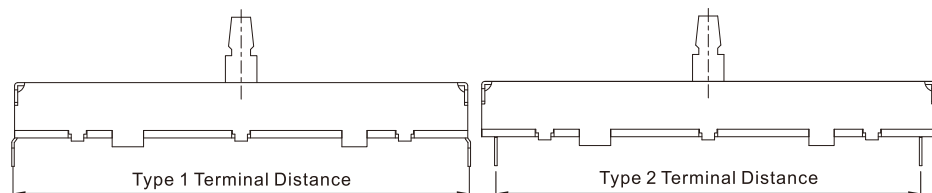

Slide Potentiometer



F4546-G1 **D** 45mm Travel, Dual Gangs, 72.5mm Terminal Pitch, D-Type Slide Rod

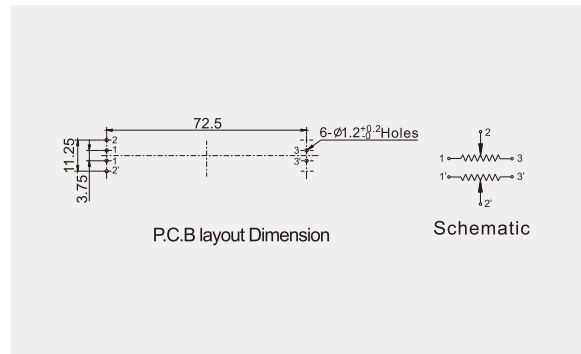
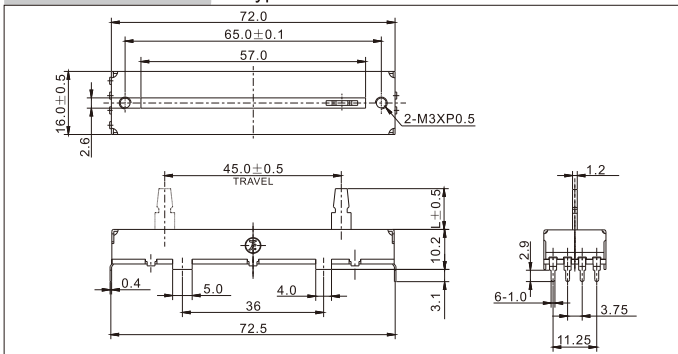

F4546-G2 **D** 45mm Travel, Dual Gangs, 67.5mm Terminal Pitch, D-Type Slide Rod

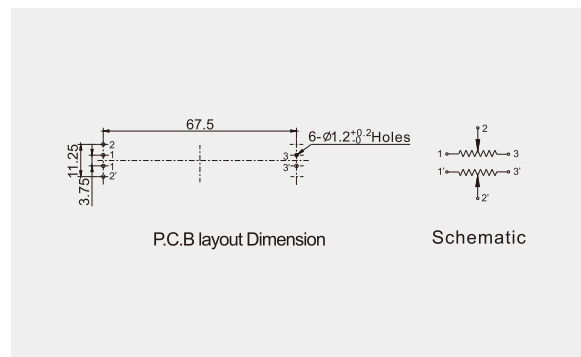
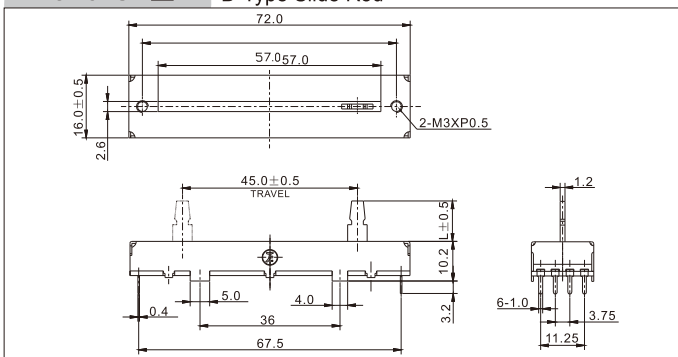

F6046-G1 **D** 60mm Travel, Dual Gangs, 87.5mm Terminal Pitch, D-Type Slide Rod

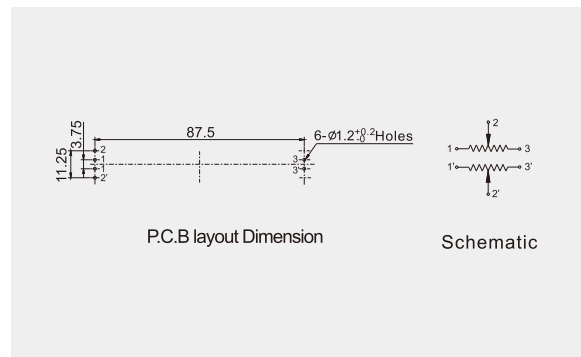
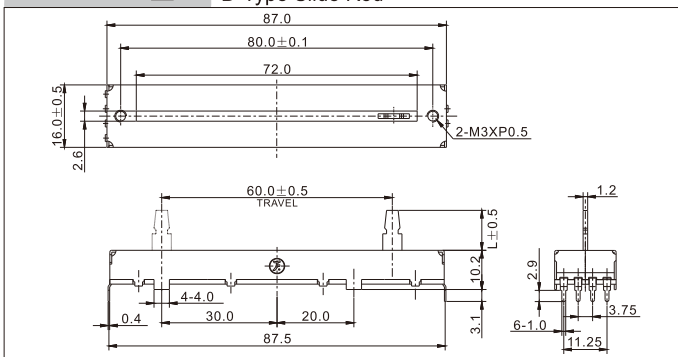

F6046-G2 **D** 60mm Travel, Dual Gangs, 82.5mm Terminal Pitch, D-Type Slide Rod

